

General instructions

Please read these safety instructions before using your device and store them for possible future reference.

1. If the cord is damaged, have it repaired by the manufacturer, its service or a similarly qualified person in order to avoid any hazard.
2. The power supply must be replaced by a new one in case of malfunction, because this power supply is not repairable.
3. The socket outlet shall be installed near the equipment and shall be easily accessible.
4. The product is not intended for use by persons (including children) with reduced physical, sensory or mental capacity. Persons who have not read the manual, unless they have received explanations by a person responsible for their safety and supervision, should not use this unit.
5. Children should be monitored to ensure that they do not play with the product.
6. The cord should always be readily accessible.
7. The device should not be exposed to dripping or splashing of water or liquids and no objects filled with liquids, e.g. flower vases, should be placed on the product.
8. The normal ventilation of the product shall not be impeded for intended use.
9. It is recommended to leave a minimum distance of 10 cm around the unit to ensure sufficient ventilation.
10. Open flame sources, such as candles, should not be placed on top of the device.
11. The device is intended for use only in a temperate climate.
12. CAUTION: Danger of explosion if battery is incorrectly replaced or not replaced by the same type or equivalent.
13. The battery should not be exposed to excessive heat such as sunshine, fire or similar.
14. Different types of batteries, new and used batteries should not be mixed.
15. The battery must be installed according to the polarity.
16. If the battery is worn, it must be removed from the product.
17. The battery must be disposed of safely. Always use the collection bins provided for recycled items in order to protect the environment.



DECLARATION OF CONFORMITY

Radio equipment and telecommunications terminal equipment, Directive 2014/53/EU
Crystal Audio hereby declares that the product, 3D-HIFI360, is in conformity with provisions of the Directive 2014/53/EU.
The complete text of the Declaration of conformity can be found on the following webpage: www.CrystalAudio.gr

Warnings

1. The **lightning flash** with the arrowhead symbol within an equilateral triangle alerts the user to the presence of un-insulated dangerous voltage within the product's enclosure that could cause electric shock.
2. The **exclamation mark** within an equilateral triangle alerts the user to the presence of important operating and maintenance instructions as well as warnings in the user's manual or on the product.

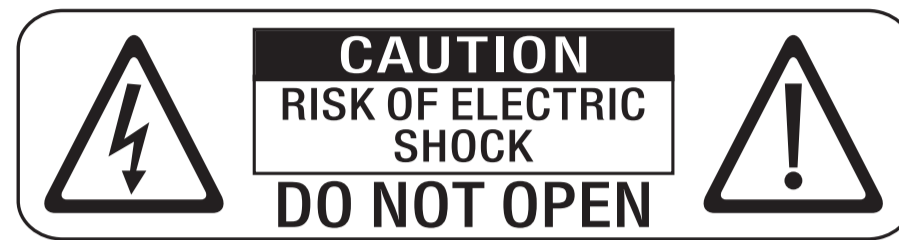

CLASS 1 LASER PRODUCT LABEL

This label is attached to the place as illustrated to inform that this device contains a laser component.

CLASS 1	LASER PRODUCT
CLASSE 1	LASER PRODUITO
KLASS 1	LASER APPARAT
KLASSE 1	LASER PRODUKT
CLASSE 1	PRODUIT LASER

CRYSTALAUDIO

WiSound

3D-HIFI360

- Quick Guide -

Thank you for purchasing Crystal Audio 3D-HIFI360 system

This mini Hi-Fi system is the answer to today's demand for great sound, offering deep and powerful bass with incredible dispersion. Small yet powerful Hi-Fi system, it produces excellent sound with realistic height from a wide sound stage.

TECHNICAL SPECIFICATIONS:

Power Output (RMS): **50W (2x 25W)**
 Max. Power Output: **75W**
 Woofer: **2x 4"**
 Tweeter: **6x 2"**
 Freq. Response: **20Hz - 20KHz**
 Impedance: **4Ω**
 S/N: **80dB**
 Frequency Ranges: **87.5 - 108MHz**
 MP3/WMA Bit Rate: **32-320Kbps (MP3)**
40-320Kbps (WMA)
 Rated Voltage: **AC 110-240V, 50/60Hz**
 Power Consumption: **75W**
 Standby Consumption: **< 0.5W**
 Dimensions (Main unit): **170x215x145mm**
 Dimensions (Speakers): **142x210x245mm (each)**

CONNECTIVITY FEATURES:

- Bluetooth® v5.0
- USB2.0 port
- ✓ up to 32Gb, FAT16/32 file system
- ✗ NTFS, ext. HDD, USB hubs/extension cables
- AUX In
- Headphones

IN THE BOX:

- 3D-HIFI360 mini Hi-Fi system
- User Manual
- Remote Control
- AUX cable (3.5mm-RCA type)
- FM Antenna cable

OTHER FEATURES:

- CD/CD-R/CD-RW/MP3/WMA
- FM Radio
- LED Display

Rear View

Front View

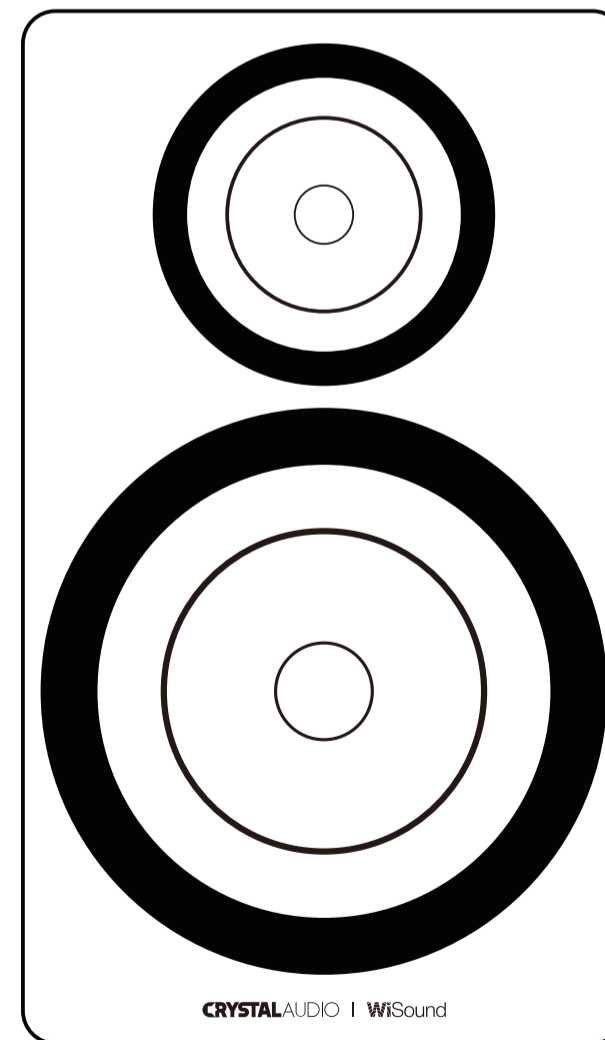
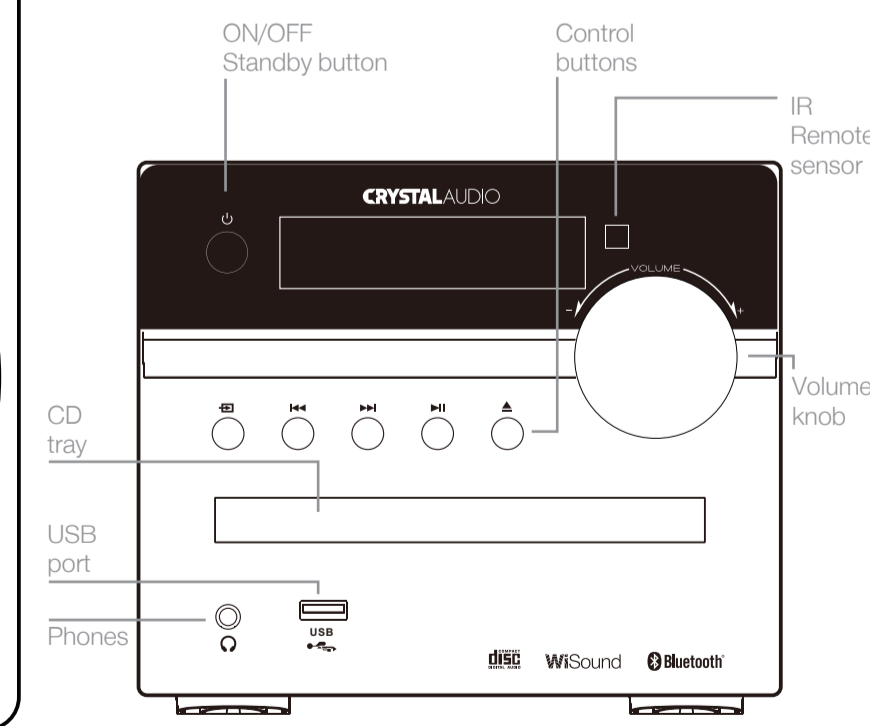
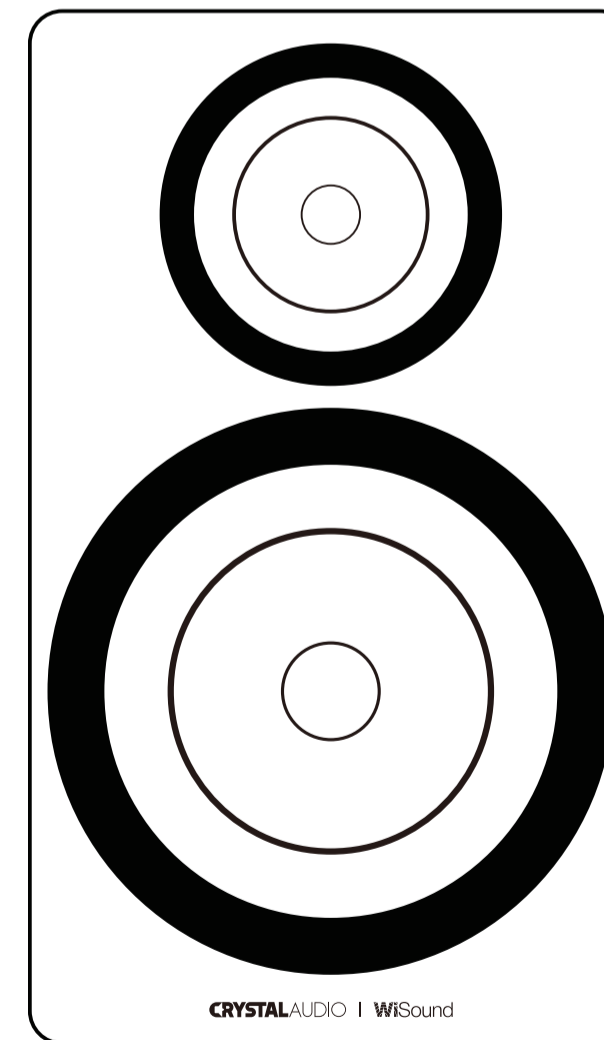
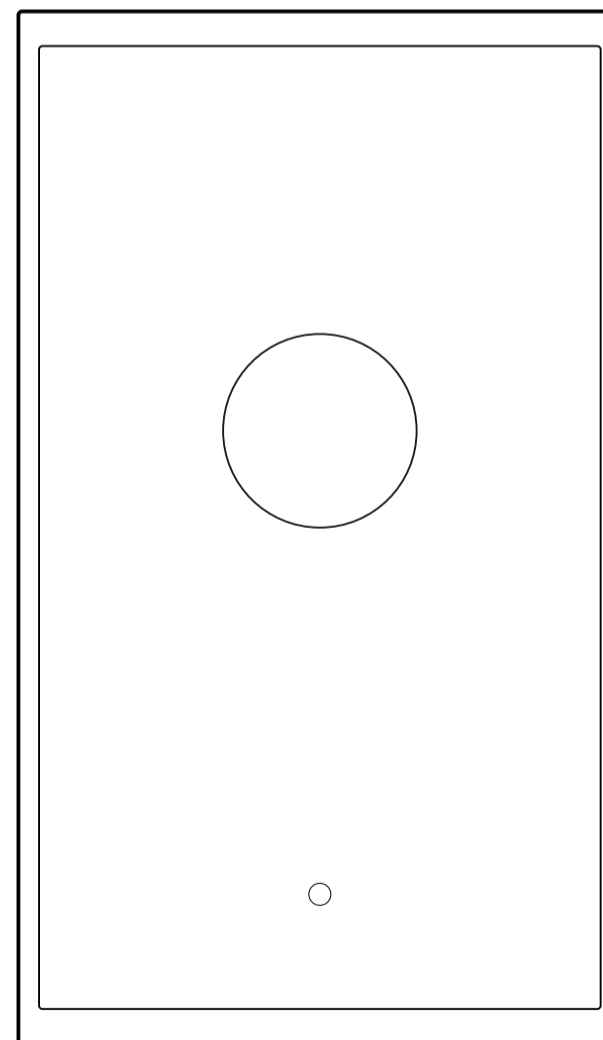
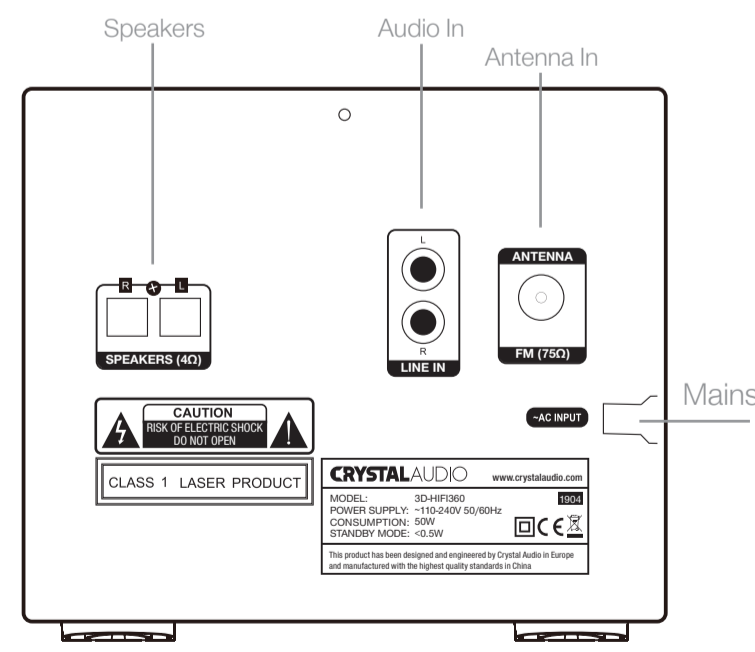
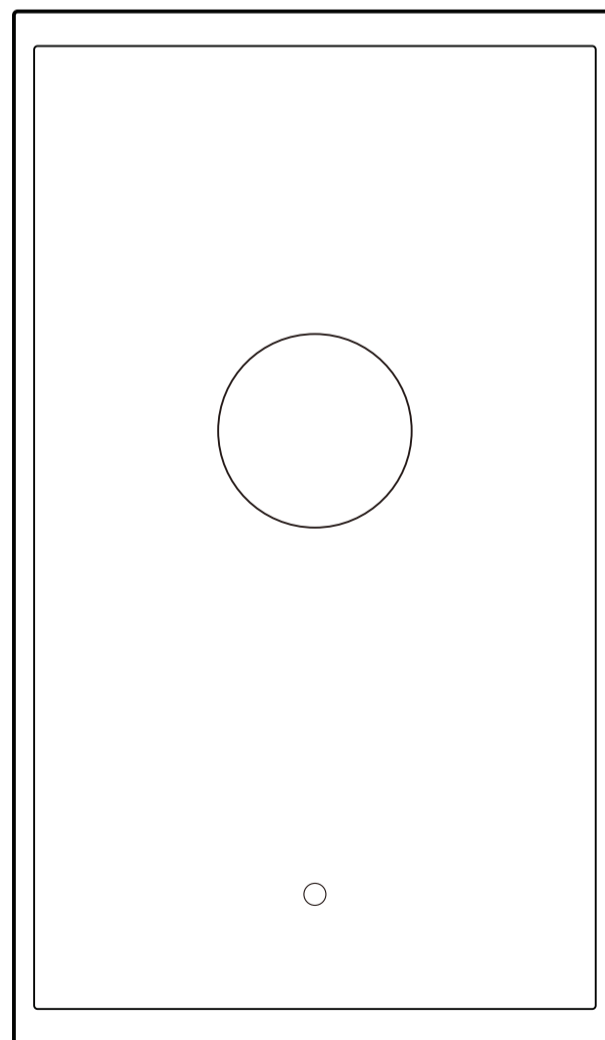

D & J DAMKALIDIS SA
 44 Zefyrou str., P. Faliro, PC 17564
 Support: 210 9410888
 email: desk@damkalidis.gr

Designed in Europe by Crystal Audio - Assembled in China with the highest quality standards.
 The Bluetooth® word mark and logos are registered trademarks owned by Bluetooth SIG Inc. and any use of such marks by Crystal Audio is under license. Other trademarks and trade names are those of their respective owners.

www.CrystalAudio.gr

1 Set it up

Connect the speakers to the unit:

Connect each speaker cable to the respective SPEAKER port.

Connect the Antenna cable:

Connect the Antenna cable to the ANTENNA FM input port.

Connect the unit to the outlet:

Connect the mains plug into the electrical outlet.

Install Batteries:

Slide out cover and place 2 AAA type batteries (not included) with polarities as shown below.

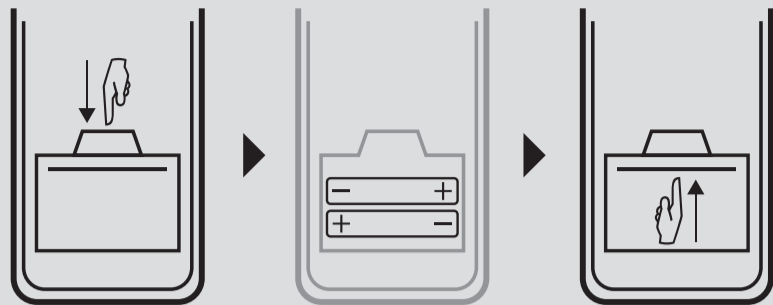

2 Pair it (wireless connection)

You can pair 3D-HIFI360 with any Bluetooth® enabled device (phone, tablet etc).

1. Press the **SOURCE** button to select **BT** (Bluetooth Mode). The indication on the LED Display **flashes continuously** and the device automatically searches for available Bluetooth devices.

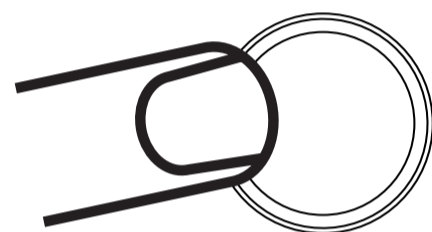

2. On your device, turn **BLUETOOTH** on and make it discoverable. Search for **3D-HIFI360** and select it.
3. The indication **stops flashing**. The devices are now **paired**.

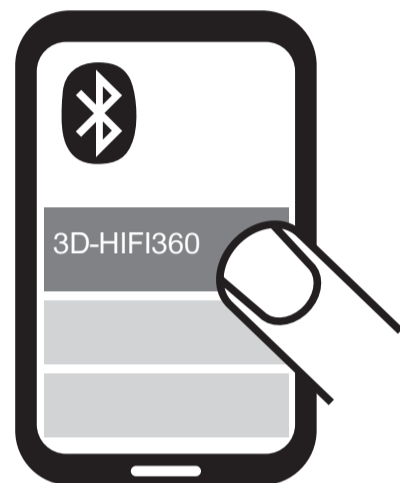

* In case of an old Bluetooth version (below v3.0) you might be asked for a code. Please enter "0000".

3 Use it (wired connection)

- LINE IN:** Connect both Left & Right channels to your device Output
- USB:** Play songs directly from your USB flash drive
- Headphones:** Connect to the headphone Output of your device

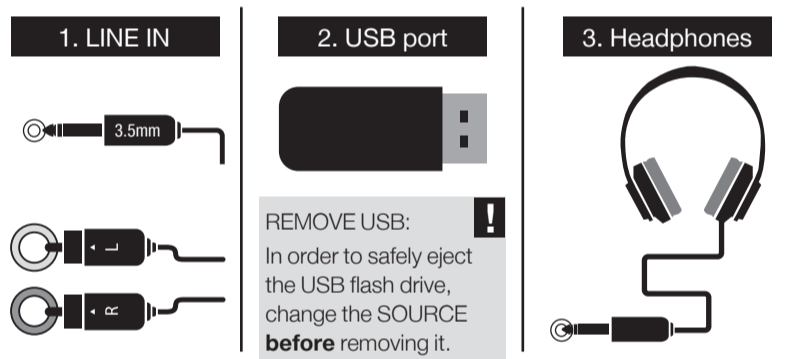

4 Select it (choose mode)

Press **SOURCE** button on the main unit or on the Remote Control to switch between the available modes.



5 Preset it (up to 40 radio stations)

- In FM mode: Press **GOTO**
- On LED display: **000.00**
- Num. Keypad:** Enter FM frequency
- Goto Frequency:** Press **PLAY**
- Once tuned: Press **MEMORY**
- Set Position:** Press **CH-/+**

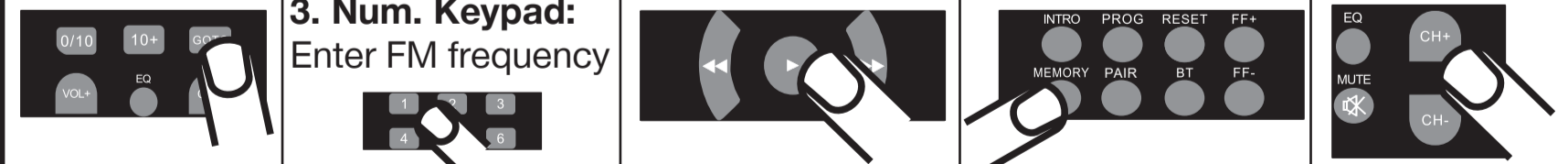

INFO:
To select a radio station press a key (1-10) on the Remote Control.
To select a station from number 11 to 40, press **10+** and enter the desired number of the station.

6 Tune it (choose radio stations)

- MANUAL**
In FM mode: Press **FF-/+**
- AUTO**
a. In FM mode: Press **Search** on Remote Control
- AUTO**
b. In FM mode: Press **PLAY/PAUSE** on the main unit

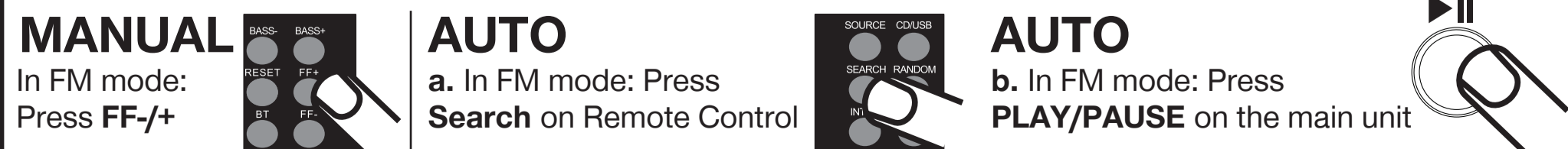

7 Program it (create a playlist, up to 9 songs)

- In CD mode:** Load a disc and press **STOP**. Press **PROG** and enter the first track number. Press **PROG** again to confirm. Enter the second number and follow the same procedure to set your playlist.
- Play the list:** When the list is completed press **PLAY** to confirm and listen to the music.

8 Loop it (play a section of a song)

In CD/MP3 mode:

- Press **A-B** button once to set **In** (Start) point.
- Press **A-B** button again to set **Out** (End) point.

Press A-B:
1x= set START point
2x= set END point
The specific part of the song will be played repeatedly.



9 Control it

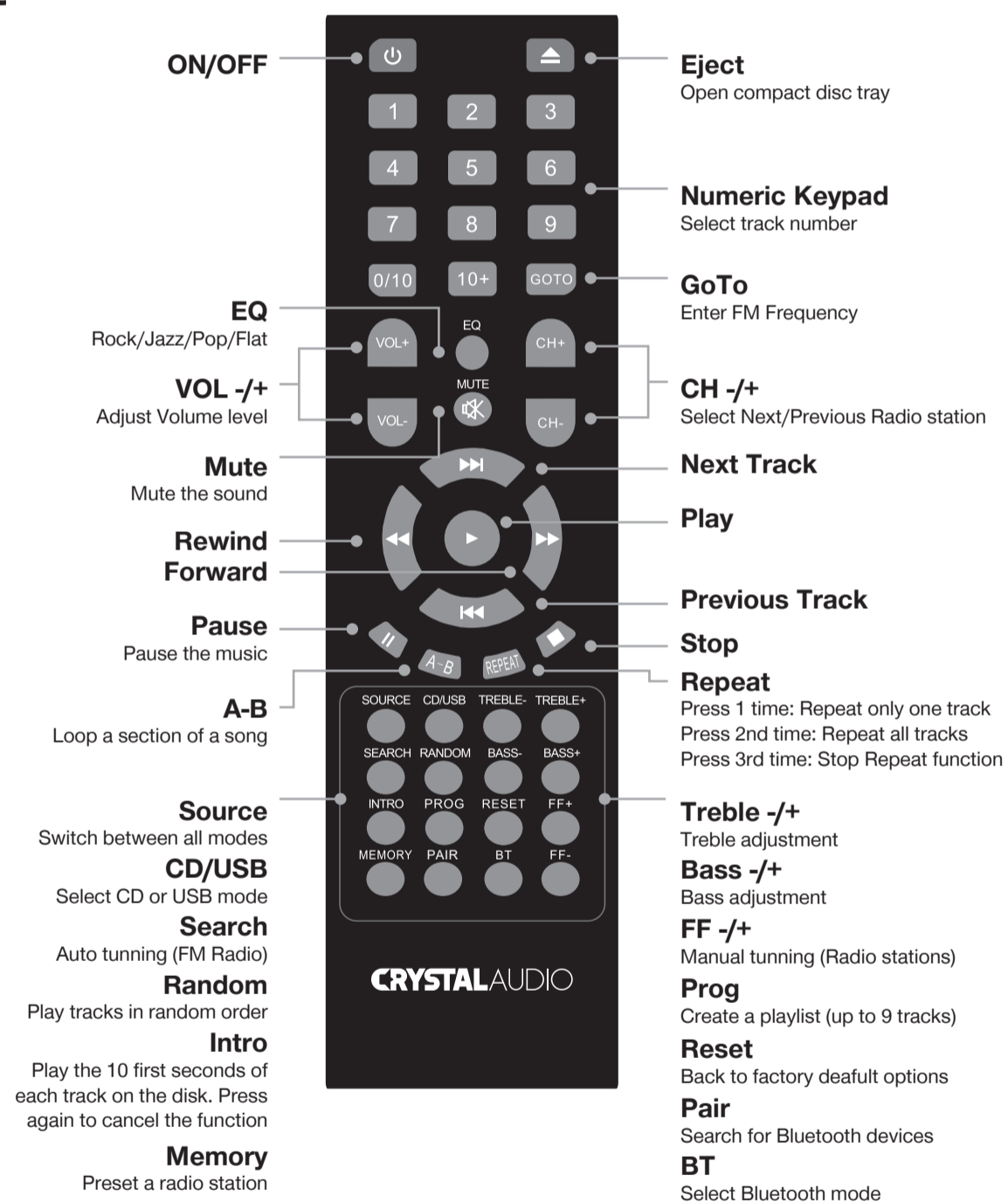

10 Care & Maintenance

Compact discs:

- Treat disc carefully holding it by its edges.
- Clean with a soft, dry cloth. Wipe from the center to the outer edge of the disc. Do not wipe in circular direction.
- Do not stick or write anything on either side of the disc.

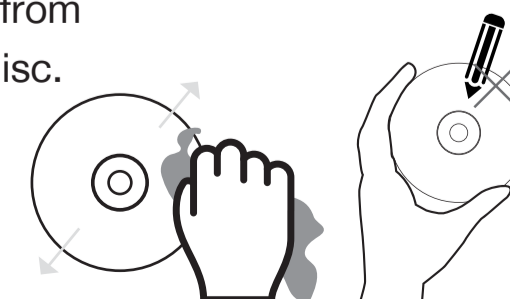

Unit:

- To prevent shock hazard disconnect from the AC power source when cleaning the device.
- Clean with a dry cloth. A damp cloth may be used on the front panel.

